

OPZIONI-OPTIONS-OPTIONEN

BAL*	BASAMENTO CROMATO FUßGESTELL VERCHROMT CHROMIUM PLATED BOARD SOCLE CHROMÉ
B-076	BASAMENTO VERNICIATO NERO FUßGESTELL SCHWARZ LACKIERT BASEMENT LAQUERED BLACK SOCLE LAQUÉ NOIR



1-Solida struttura in legno. 3-Poliuretano espanso.
9-Poliuretano espanso pregiato. 24-Fibra di poliestere accoppiata a tessuto di cotone. 30-Telaio tubolare metallico con cinghie elastiche. 31-Gambe in metallo cromato.

1-Sturdy inner wooden frame. 3-Expanded polyurethane.
9-High-grade expanded polyurethane. 24-Polyester fibre joined with cotton fabric. 30-Tubular metallic frame with elastic straps. 31-Chromed metallic feet.

1-Structure in bois solide. 3-Polyuréthane expansé.
9-Polyuréthane expansé haute qualité. 24-Fibre de polyester avec tissu de coton. 30-Châssis métallique tubulaire avec sangles élastiques. 31-Pieds en métal chromée.

1-Stabiles Holzgestell. 3-Polyuretanschaum.
9-Hochwertiger Polyuretanschaum. 24-Polyesterfaser mit Baumwollauflage. 30-Metallrohrrahmen mit elastischen Gurten. 31-Verchromte Metallfüße.

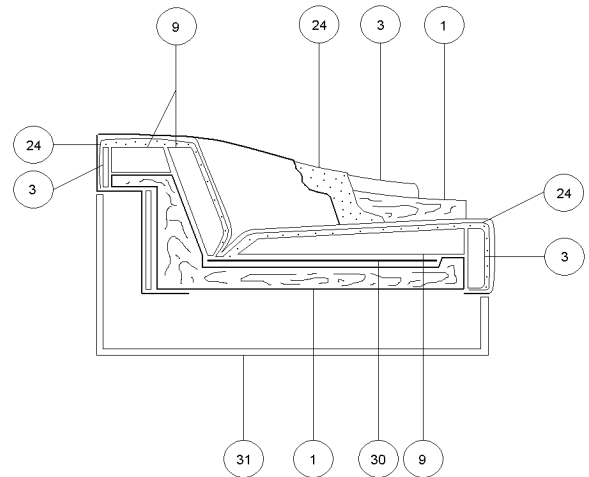

* Opzione Standard; sarà montato qualora non vi siano richieste specifiche nell'ordine
Standard Option; will be assembled as far as no specific requests are mentioned in the order.
Option Standard; il sera monté, si n'y a pas demandes spécifiques sur la commande.
Standard Option; wird montiert, wenn auf dem Auftrag keine spezifischen Ausführung angegeben ist.

L=Lunghezza,P=Profondità,H=Altezza,Hs=Altezza Seduta,Ps=Profondità Seduta,HBr=Altezza Bracciolo,LBr=Larghezza Bracciolo
L=Lenght,P=Deep,H=Height,Hs=Seat Height,Ps=Seat deep,HBr=Armrest Height,LBr=Armrest Breadth
L=Longeur,P=Profondeur,H=Hauteur,Hs=Hauteur d'assise,Ps=Profondeur d'assise,HBr=Hauteur d'accoudoir,LBr=Largueur d'accoudoir
L=Länge,P=Tiefe,H=Höhe,Hs=Sitzhöhe,Ps=Sitztiefe,HBr=Armlehnhöhe,LBr=Armlehnbreite

Tutti i prezzi sono in Euro All Price are in Euro Toutes les prix sont en Euro Alle Preise sind in Euro

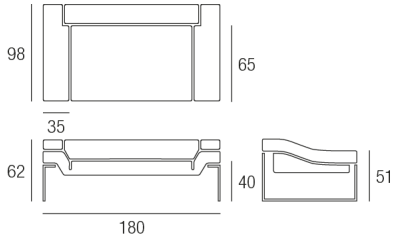

2

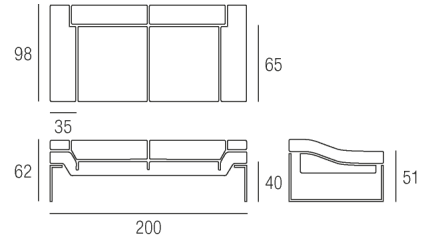

2MAX

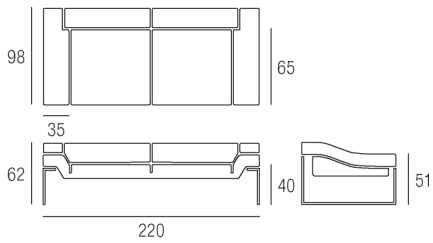

3

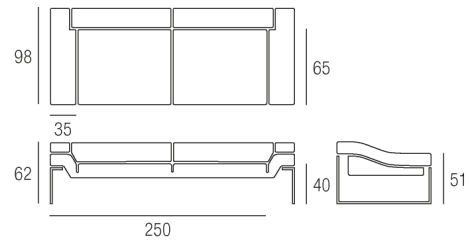

3MAX

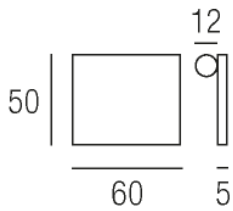

CSSM-RL

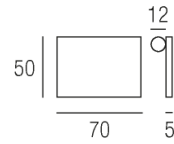

CSMD-RL

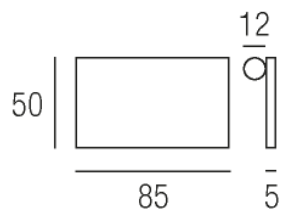

CSGR-RL

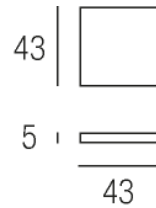

CS-